

Solutions for your rendering needs

fassarend

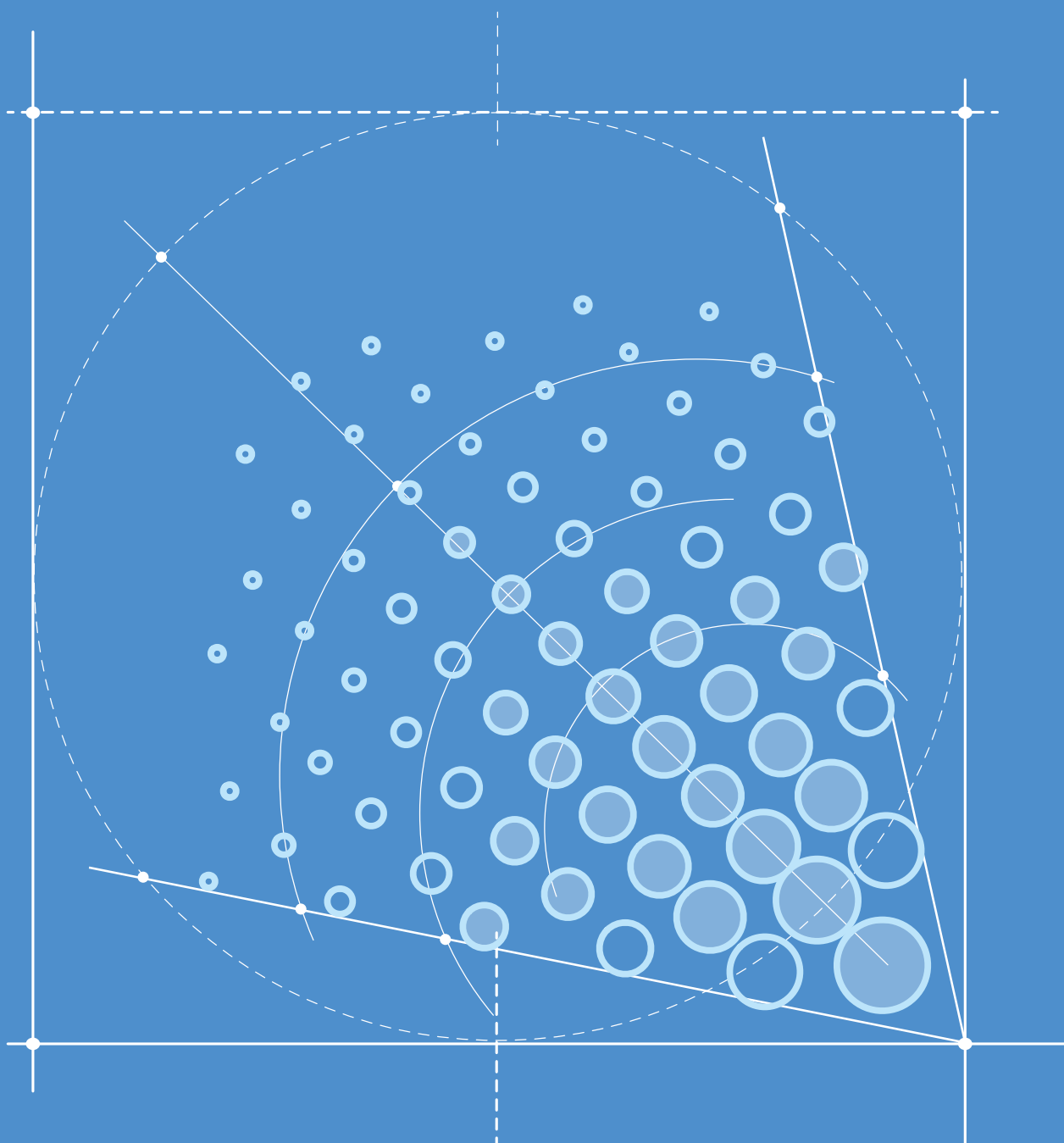

FASSA
BORTOLO

GENERAL INDEX

INTRODUCTION

Our experience is your guarantee	4-5
Solid roots for development objectives	6-7
Certified quality for the building sector	8-9

FASSAREND CYCLES

1. RENDERING ONTO AERATED BLOCKWORK 12-13

CYCLE 01 Complete cycle with base coat + finish with mesh + ready-to-use topcoat	p.12
--	------

2. RENDERING ONTO MEDIUM DENSE BLOCKWORK 14-21

CYCLE 2A Basic application: render + ready-to-use topcoat	p.14
CYCLE 2B Solution with base coat + mesh + mineral finish + paint	p.16
CYCLE 2C Solution with base coat + mesh + ready-to-use topcoat	p.18
CYCLE 2E Cycle with one-coat render	p.20

3. RENDERING ONTO BRICKWORK 22-29

CYCLE 3A Complete cycle with render + finish with mesh + paint	p.22
CYCLE 3B Complete cycle with render + mesh + mineral finish + paint	p.24
CYCLE 3C Complete cycle with render + mesh + ready-to-use topcoat	p.26
CYCLE 3D Cycle with one-coat render	p.28

4. RENDERING ON CONCRETE 30-37

CYCLE 4A Complete cycle with render + finish with mesh + paint	p.30
CYCLE 4B Cycle with render + mineral finish + paint	p.32
CYCLE 4C Complete cycle with render + mesh + ready-to-use topcoat	p.34
CYCLE 4D Cycle with one-coat render	p.36

5. RENDER CARRIER BOARD 38-39

CYCLE 5A Cycle with skim coat + mesh + ready-to-use topcoat	p.38
---	------

6. RENDERING ON PAINTED SURFACE (NON-ABSORBENT PAINT)	40-43
CYCLE 6A Cycle with skim coat + mesh + ready-to-use topcoat	p.40
CYCLE 6B Cycle with skim coat + mesh + mineral finish + paint	p.42
7. RENDERING ON PAINTED SURFACE (MINERAL PAINT, ABSORBENT)	44-47
CYCLE 7A Cycle with skim coat + mesh + ready-to-use topcoat	p.44
CYCLE 7B Cycle with skim coat + mesh + mineral finish + paint	p.46

FASSAREPAIR CYCLES

8. BASE COAT AND CORRECTION OF UNEVENNESS ON CONCRETE (UP TO 10 MM)	50-53
CYCLE 8A Cycle with skim coat + mesh + ready-to-use topcoat	p.50
CYCLE 8B Cycle with skim coat + mesh + elastomer paint	p.52
9. STRUCTURAL REPAIR OF CONCRETE	54-57
CYCLE 9A Cycle with repair mortar + skim coat with mesh + ready-to-use topcoat	p.54
CYCLE 9B Cycle with repair mortar + skim coat with mesh + elastomer paint	p.56

PRODUCTS

RENDERS	60-67	PRIMERS AND DECORATIVE COATS	68-72
FASSA MS 20	p.60	FX 526	p.68
SP 22	p.60	MIKROS 001	p.69
KZ 35	p.61	PX 505	p.69
FASSA K-OVER PLUS 3.30	p.61	SKIN 432	p.70
KD 2	p.62	C 285 BETON-E	p.70
KC 1	p.62	RX 561	p.71
KI 7	p.63	RTA 549	p.71
S 650	p.63	IS 510	p.72
S 605	p.64		
RM 200	p.64	GYPSOTECH PLASTERBOARD SYSTEM	73
FASSAFER MONO	p.65	EXTERNA LIGHT	p.73
SPECIAL WALL B 550 M	p.65	MESH TAPE	p.73
A 64 R-EVOLUTION	p.66		
FASSACOUCHE	p.66		
FASSANET 160	p.67		
FASSANET MAXI	p.67		
A 96	p.68		

OUR EXPERIENCE IS YOUR GUARANTEE

Fassa Bortolo's tradition stretches back to 1710. Passed down from generation to generation, it has constantly evolved, standing out for innovations which have made an essential contribution to the construction sector.

In Italy, it was the first company to introduce premixed lime, cement plasters and renders for all types of building work. It was also the first to develop silo technology, the supply system which revolutionised work on site.

Today, it is a market leader and a reference point for designers, suppliers and the contractors themselves.

QUALITY BUILDING AND LIVING IN RESPECT OF PEOPLE AND THE ENVIRONMENT

Our experience is your guarantee of quality building and living, in respect of man and the environment.

One philosophy runs through the whole Fassa Bortolo product portfolio: a mission to bring innovations into our working and living surroundings. Developing products and materials with far better performance and improving the physiological well-being of the individual, whilst being in harmony with the environment.

Safety, efficiency, durability... here at Fassa Bortolo, our values have also always included comfort, balance and respect, because we are committed to evolution of the building sector and improving quality of life.

We combine all our resources to achieve one single objective - greater well-being and better quality of life.



300 YEARS OF HISTORY 15 SYSTEMS



SOLID ROOTS FOR DEVELOPMENT OBJECTIVES

Fassa Bortolo's history dates back all the way to 1710, yet it is in an old factory from the early 1900s, the former Opificio Lazzaris in Spresiano and currently home to management offices, where our industrial vision began, leading to a series of major expansion projects on national and international markets. An important site where ideas continuously come to fruition, a sort of incubator that promotes and supports competitive challenges.

Development ideas that continue to lay new foundations for a dynamic and extensive presence, always close to the customer. Ideas of progress whose strategic foundation lies in the skills of the people who run the company today, and those who are preparing to accompany it in the future.

A strategically-located presence, with "zero mile" products and special attention to sustainability, reducing pollution from transport and limiting the amount of exhaust gases and tyre rubber in the environment. To continue to offer the building industry that superior quality that today's construction and renovation market demands.

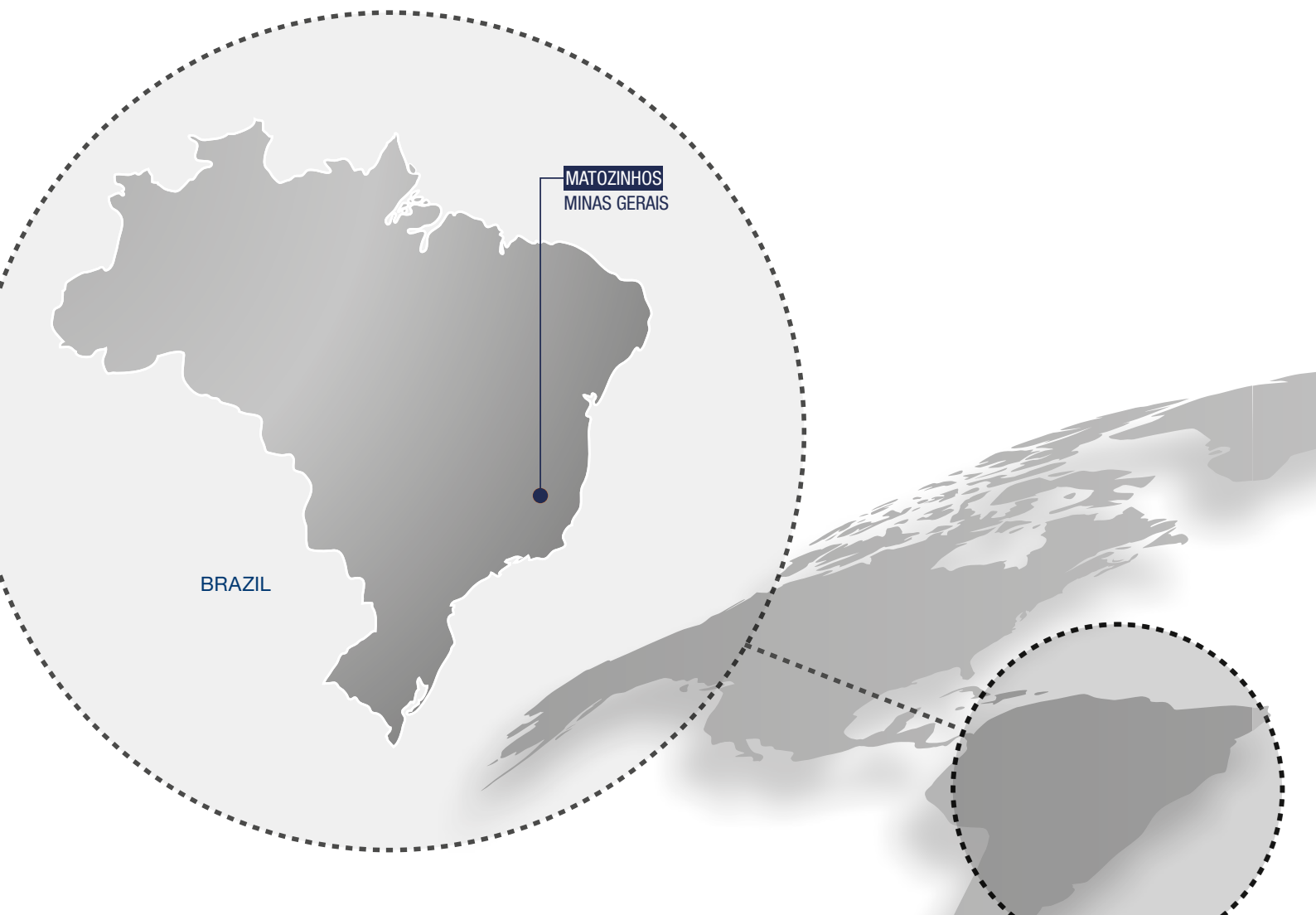

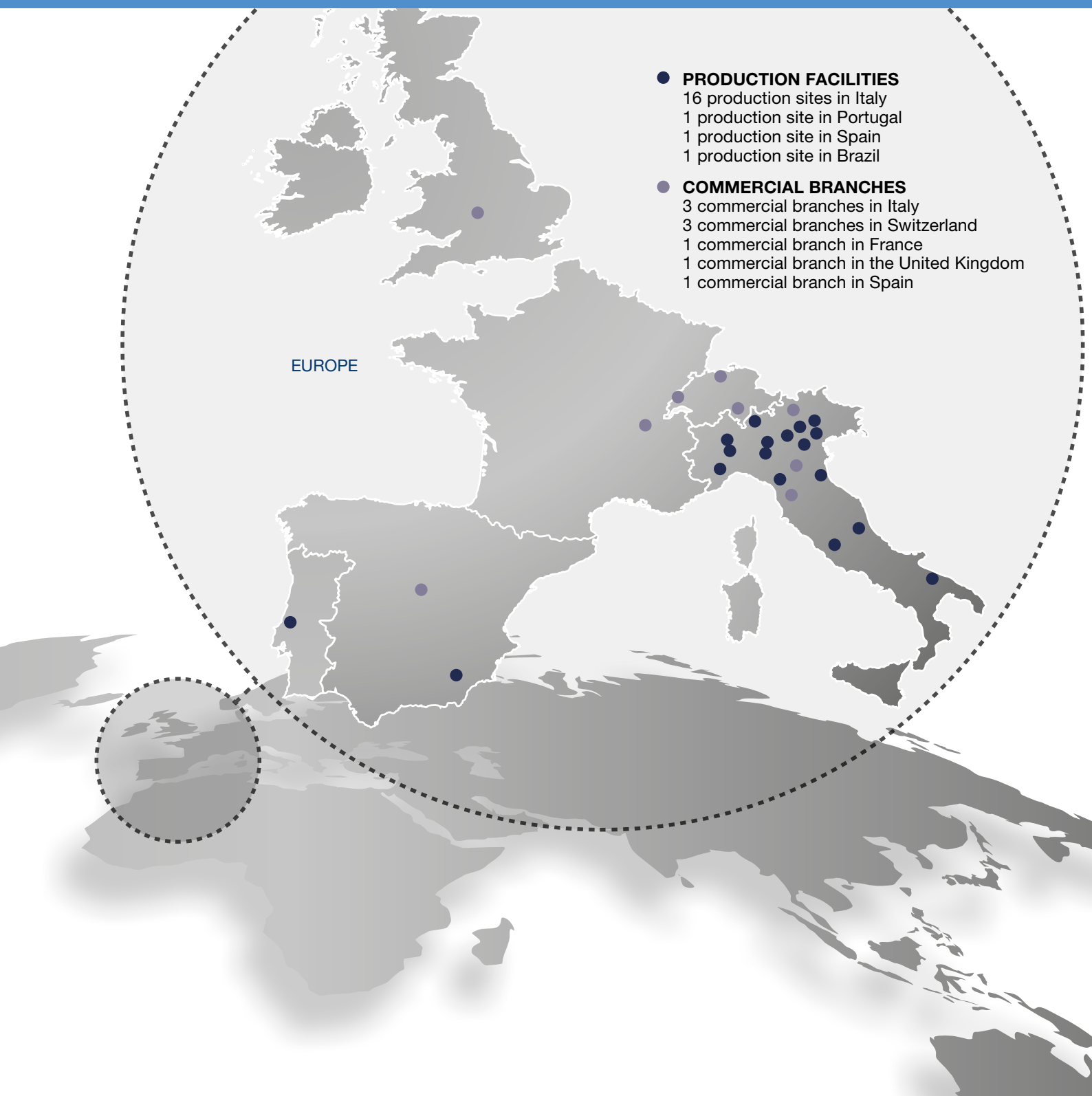

CERTIFIED QUALITY FOR THE BUILDING SECTOR

Fassa Bortolo also proves its attention to sustainable development through its active work on the market as a member of GBC Italia (Green Building Council) and as a partner of CasaClima and Legambiente Onlus.



UKCA

The UKCA (UK Conformity Assessed) marking is a new UK product marking that is used for goods being placed on the market in Great Britain (England, Wales and Scotland). It covers most goods which previously required the CE marking, known as 'new approach' goods.



BRITISH BOARD OF AGRÉMENT (BBA)

The BBA has certified our FASSACOUCHÉ as well as our FASSATHERM External Wall Insulation System on masonry: the latter was a necessary requirement to extend the offering of the Fassatherm, already with European Technical Approval (ETA), specifically to the British market.



BDA AGRÉMENT

KIWA has certified the FASSATHERM External Wall Insulation System on steel frame structure and the "FASSAREND" system with A 96 on a cement based render carrier board, for installation on external timber framed or solid walls. The BDA Agrément has received the NHBC third party acceptance for the UK market.



EUROPEAN TECHNICAL APPROVAL (ETA) AND SAFETY IN ALL COMPONENTS

From insulation to adhesive/base coat, anchors and reinforcing bars, all elements in the FassathermR External Thermal Insulation Composite System are submitted to the strictest controls possible. The Fassatherm® External Thermal Insulation Composite System has obtained European Technical Approval (ETA) that attests its technical suitability for thermal insulation applications.



CONSTRUCTION PRODUCTS REGULATION CPR 305/2011 – CE MARKING AND DOP

All Fassa products comply with EC standards and regulations, satisfy all the performance requisites for building products (CPR 305/2011) and bear CE and DoP marking. The DoPs (Declarations of Performance) for Fassa Bortolo and Gypsotech products can be downloaded from our website www.fassabortolo.com. All technical documentation bears special logos highlighting possession of these requisites, while others confirm compliance to the criteria and classification methods specified in European standards and regulations.

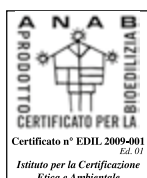

ANAB (ASSOCIAZIONE NAZIONALE ARCHITETTURA BIOECOLOGICA) AND ICEA (ISTITUTO PER LA CERTIFICAZIONE ETICA E AMBIENTALE) QUALITY CERTIFICATION

This represents important recognition for our bio-ecological products, certifying maximum care paid to the environment and complete compliance with the strictest bioarchitecture criteria. Fassa Bortolo's Bio-Architecture line was the first line in Europe to obtain certification with KB 13, the first plaster certified in 1999, setting the standards in the sustainable architecture sector.



GEV EMICODE

Voluntary mark certifying the emission of volatile and semi-volatile organic compounds (VOC and SVOC) issued by GEV (Association for the Control of Emissions in Products for Floor Installation, Adhesives and Building Materials), applied to the products in the System for Laying Floor and Wall Coverings. Following severe tests, the very low emissions of Fassa products earned them EC1^{Plus} certification.



INDOOR AIR QUALITY

All products in the Fassa Bortolo Colour System respect the parameters established by European Union regulations and standards aimed at limiting the emission of organic compounds. They therefore comply with the provisions of Italian Legislative Decree no. 161 of 27/03/2006 (implementing Directive 2004/42/EC), identifying the maximum content of Volatile Organic Compounds (COVs) in paints and paste coatings.

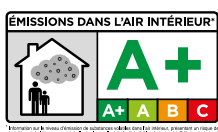

FRENCH LABEL - ÉTIQUETAGE SANITAIRE

Classification and labelling system applied to emissions of Volatile Organic Compounds (VOCs) from construction and decoration products and indoor finishes, required for the French market.



QB CERTIFICATION

This certification classifies the performance of tile cements and adhesives and the implementation and application of production control system capable of ensuring constant product quality.

FASSAREND CYCLES



FASSAREND CYCLES



CYCLE 01

RENDERING ONTO AERATED BLOCKWORK (3.5 KN)

Complete cycle with base coat + finish with mesh + ready-to-use topcoat



1 KD 2

2 KZ 35

3 S 605

4 FASSANET 160

5 FX 526

6 RX 561/ RTA 549

Rendering cycle for lightweight block substrates (3.5 kN block with a density > 450 kg/m³) with fibre-reinforced lime and cement render. Application of a reinforced skim coat using FASSANET 160 fibreglass mesh minimises the risk of hairline cracks forming. Ready-to-use acrylic-siloxane finish coat plaster/render that combines excellent water repellency and good breathability. Available in different gradings and colours.

- Fibre-reinforced base coat render
- Excellent water repellency and good breathability
- Minimises the risk of hairline cracks

BASE COAT



KD 2
Lime-and-cement-based fibre-reinforced base coat plaster/render.



KZ 35 (base area)
Lime/cement base coat plaster/render with water-repellent properties for base areas.

FINISH COAT



S 605
Bio white finish coat plaster/render for the restoration of damp masonry, with marmorino effect.



FASSANET 160
Alkali-resistant fibreglass reinforcing mesh, 160 g/m².

PRIMER AND DECORATIVE COAT



FX 526
Universal pigmented primer undercoat for interiors and exteriors.



RX 561
Rustic acrylic siloxane top coat for exteriors.

OR



RTA 549
Acrylic coating for thermal insulated walls for exteriors.

RENDERING ONTO MEDIUM DENSE BLOCKWORK (7.3 KN)

Basic application: render + ready-to-use topcoat

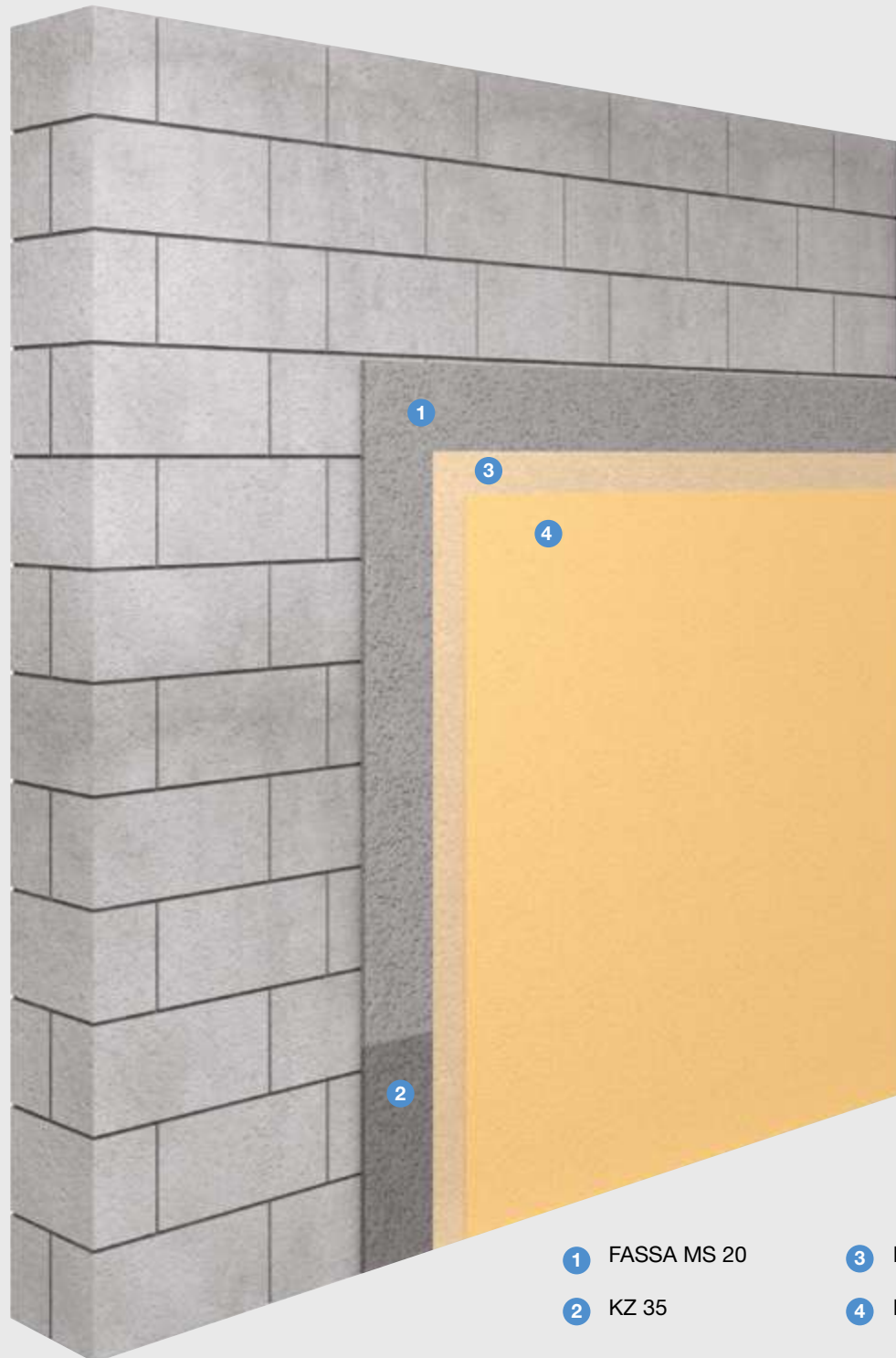

1 FASSA MS 20

2 KZ 35

3 FX 526

4 RX 561

Basic application cycle with cement base coat render and painting. For the base area, it is recommended to apply a specific lime and cement render with low water absorption.

■ Basic solution

■ Ready-to-use decorative render with rustic texture

BASE COAT



FASSA MS 20
General purpose rendering/
plastering mortar



KZ 35 (base area)
Lime/cement base coat plaster/render with
water-repellent properties for base areas.

PRIMER AND DECORATIVE COAT



FX 526
Universal pigmented
primer undercoat for
interiors and exteriors.



RX 561
Rustic acrylic siloxane top
coat for exteriors.

RENDERING ONTO MEDIUM DENSE BLOCKWORK (7.3 KN)

Solution with base coat + mesh + mineral finish + paint



- 1 KC 1/ KI 7
- 2 KZ 35
- 3 FASSANET MAXI

- 4 RM 200
- 5 MIKROS 001/ FX 526
- 6 SKIN 432

This application cycle involves application of a lime and cement base coat render with FASSANET MAXI alkali-resistant fibreglass mesh embedded in the surface layer of the base coat render (1/3 from the outer surface). For the base area, it is recommended to apply a specific lime and cement render with low water absorption. Choosing a hydrated lime mineral finish gives the surfaces high aesthetic value and good breathability. The use of a protective siloxane paint provides greater resistance to the weather.

- Greater weather resistance
- Good breathability
- High aesthetic value
- Mineral finish
- Optimum water repellency

BASE COAT



KC 1
Lime and cement base coat plaster/ render.

OR



KI 7
Fibre reinforced lime/cement base coat plaster and render with water-repellent properties.



FASSANET MAXI
Alkali-resistant fibreglass reinforcing mesh, 160 g/m².



KZ 35 (base area)
Lime/cement base coat plaster/render with water-repellent properties for base areas.

FINISH COAT



RM 200
Bio white mineral-based wall coating for exteriors and interiors.

PRIMER AND DECORATIVE COAT



FX 526
Universal pigmented primer undercoat for interiors and exteriors.

OR



MIKROS 001
Wall primer in water microemulsion.



SKIN 432
Protective siloxane finish for exteriors.

RENDERING ONTO MEDIUM DENSE BLOCKWORK (7.3 KN)

Solution with base coat + mesh + ready-to-use topcoat



- 1 KI 7
- 2 KZ 35
- 3 FASSANET 160

- 4 FX 526
- 5 RX 561

This application cycle involves application of a lime and cement base coat render with FASSANET 160 alkali-resistant fibreglass mesh embedded in the surface layer of the base coat render (1/3 from the outer surface)
For the base area, it is recommended to apply a specific lime and cement render with low water absorption.
Choosing a ready-to-use acrylic-siloxane finish coat render, available in different gradings and colours, combines excellent water repellency with good breathability.

■ Ready-to-use decorative render
with rustic texture

■ Optimum water repellency
■ Good breathability

BASE COAT



K17
Fibre reinforced lime/cement base coat plaster and render with water-repellent properties.



KZ 35 (base area)
Lime/cement base coat plaster/render with water-repellent properties for base areas.



FASSANET 160
Alkali-resistant fibreglass reinforcing mesh, 160 g/m².

PRIMER AND DECORATIVE COAT



FX 526
Universal pigmented primer undercoat for interiors and exteriors.



RX 561
Rustic acrylic siloxane top coat for exteriors.

RENDERING ONTO MEDIUM DENSE BLOCKWORK (7.3 KN) *Cycle with one-coat render*

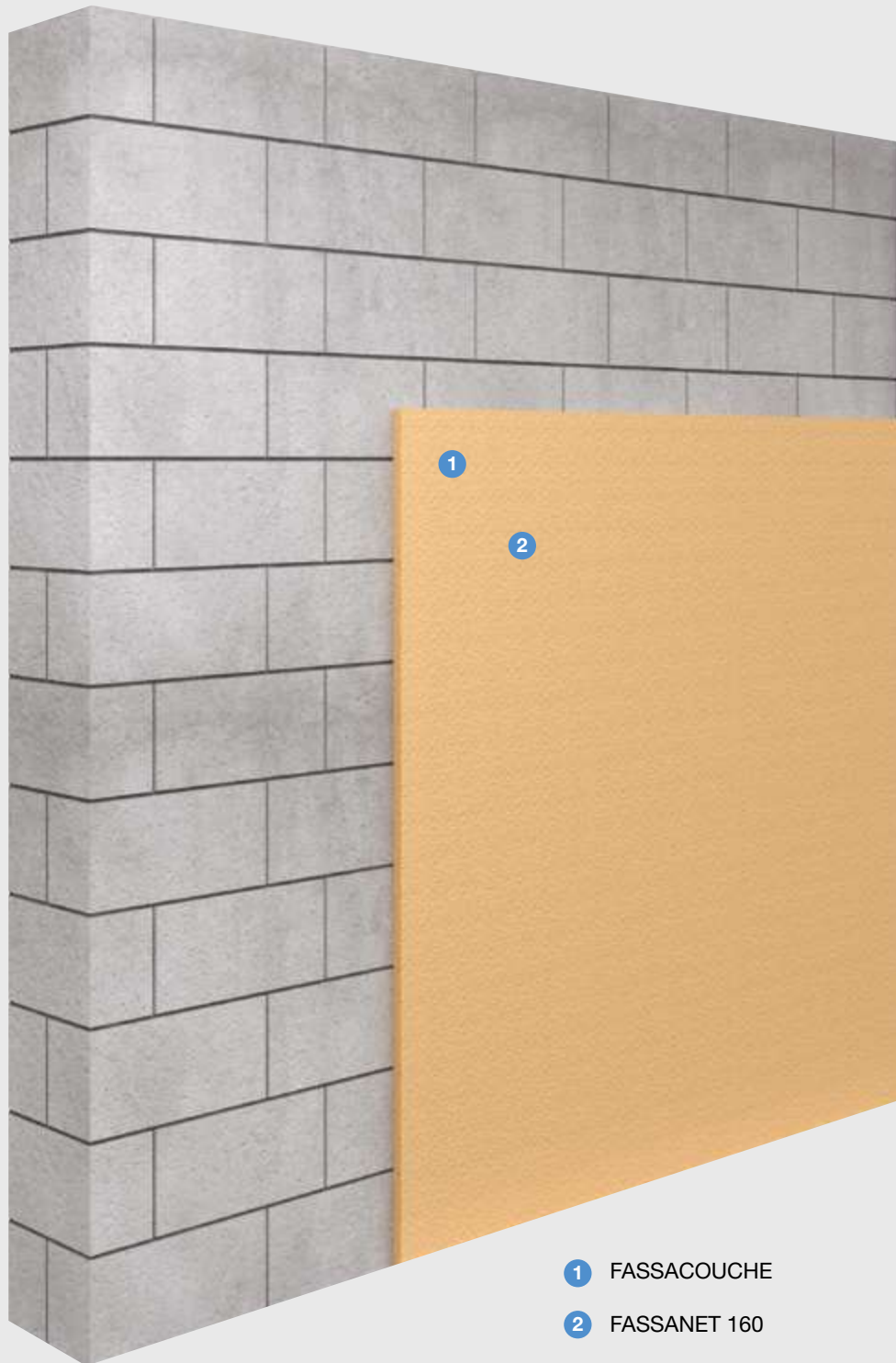

- 1 FASSACOUCHE
- 2 FASSANET 160

Rendering cycle using semi-lightweight through-coloured render made from hydrated lime and white hydraulic binder; the product combines high water repellency and excellent breathability and allows four different finishes: smooth, scratched, sponged, sponge-floated.

- Through-coloured render
- High aesthetic value
- Certified in accordance with BBA
- Good water repellency
- Excellent breathability
- Excellent workability

BASE COAT



FASSACOUCHE
Semi-lightweight through-coloured render for protecting and decorating facades.



FASSANET 160
Alkali-resistant fibreglass reinforcing mesh, 160 g/m².

EXTRA TOP COAT



IS 510
Siloxane water-repellent.

OR



PX 505
Acrylic-siloxane filling finish for exteriors.

RENDERING ONTO BRICKWORK

Complete cycle with render + finish with mesh + paint



1 SP 22

2 KI 7/ KC 1

3 KZ 35

4 S 605

5 FASSANET 160

6 MIKROS 001/FX 526

7 SKIN 432

Complete application cycle for different types of bricks (including engineering bricks), involving application of a cement undercoat to improve adhesion and ensure uniform substrate absorption, followed by lime and cement base coat render. For the base area, it is recommended to apply a specific render with low water absorption. Application of a reinforced base coat using FASSANET 160 fibreglass mesh minimises the risk of hairline cracks forming. The protective siloxane finish gives the substrate good water repellency.

- Minimises the risk of hairline cracks
- Helps minimise any stress in the substrate
- Optimum water repellency
- Complete cycle

UNDERCOAT



SP 22
High performance cement undercoat for concrete substrates for exteriors and interiors.

BASE COAT



KC 1
Lime and cement base coat plaster/render.

OR



KI 7
Fibre reinforced lime/cement base coat plaster and render with water-repellent properties.



KZ 35 (base area)
Lime/cement base coat plaster/render with water-repellent properties for base areas.

FINISH COAT



S 605
Bio white finish coat plaster and render for the restoration of damp masonry, with marmorino effect.



FASSANET 160
Alkali-resistant fibreglass reinforcing mesh, 160 g/m².

PRIMER AND DECORATIVE COAT



FX 526
Universal pigmented primer undercoat for interiors and exteriors.

OR



MIKROS 001
Wall primer in water microemulsion.



SKIN 432
Protective siloxane finish for exteriors.

RENDERING ONTO BRICKWORK

Complete cycle with render + mesh + mineral finish + paint



1 SP 22

2 KI 7/ KC 1

3 KZ 35

4 FASSANET MAXI

5 RM 200

6 MIKROS 001/ FX 526

7 SKIN 432

Application cycle for different types of bricks (including engineering bricks), involving application of a cement undercoat to improve adhesion and ensure uniform substrate absorption, followed by lime and cement base coat render with FASSANET MAXI alkali-resistant fibreglass mesh embedded in the surface layer (1/3 from the outer surface). For the base area, it is recommended to apply a specific render with low water absorption. Choosing a hydrated lime mineral finish gives the surfaces high aesthetic value and good breathability. The use of a protective siloxane paint provides greater resistance to the weather.

■ Greater weather resistance

■ High aesthetic value

■ Optimum water repellency

■ Good breathability

UNDERCOAT



SP 22

High performance cement undercoat for concrete substrates for exteriors and interiors.

BASE COAT



KC 1

Lime and cement base coat plaster/render.

OR



KI 7

Fibre reinforced lime/cement base coat plaster and render with water-repellent properties.



KZ 35 (base area)

Lime/cement base coat plaster/render with water-repellent properties for base areas.



FASSANET MAXI

Alkali-resistant fibreglass reinforcing mesh, 160 g/m².

FINISH COAT



RM 200

Bio white mineral-based wall coating for exteriors and interiors.

PRIMER AND DECORATIVE COAT



FX 526

Universal pigmented primer undercoat for interiors and exteriors.

OR



MIKROS 001

Wall primer in water microemulsion.



SKIN 432

Protective siloxane finish for exteriors.



RENDERING ONTO BRICKWORK

Complete cycle with render + mesh + ready-to-use topcoat



- | | | | |
|---|------------|---|---------------|
| 1 | SP 22 | 4 | FASSANET MAXI |
| 2 | KI 7/ KC 1 | 5 | FX 526 |
| 3 | KZ 35 | 6 | RX 561 |

Complete application cycle for different types of bricks (including engineering bricks), involving application of a cement undercoat to improve adhesion and ensure uniform substrate absorption, followed by lime and cement base coat render with FASSANET MAXI alkali-resistant fibreglass mesh embedded in the surface layer (1/3 from the outer surface). For the base area, it is recommended to apply a specific render with low water absorption. Choosing a ready-to-use acrylic-siloxane finish coat render, available in different gradings and colours, combines excellent water repellency with good breathability.

■ Ready-to-use decorative render with rustic texture

■ Optimum water repellency
■ Good breathability

UNDERCOAT



SP 22
High performance cement undercoat for concrete substrates for exteriors and interiors.

BASE COAT



KC 1
Lime and cement base coat plaster/render.

OR



KI 7
Fibre reinforced lime/cement base coat plaster and render with water-repellent properties.



KZ 35
Lime/cement base coat plaster/render with water-repellent properties for base areas.



FASSANET MAXI
Alkali-resistant fibreglass reinforcing mesh, 160 g/m².

PRIMER AND DECORATIVE COAT



FX 526
Universal pigmented primer undercoat for interiors and exteriors.



RX 561
Rustic acrylic siloxane top coat for exteriors.

RENDERING ONTO BRICKWORK

Cycle with one-coat render

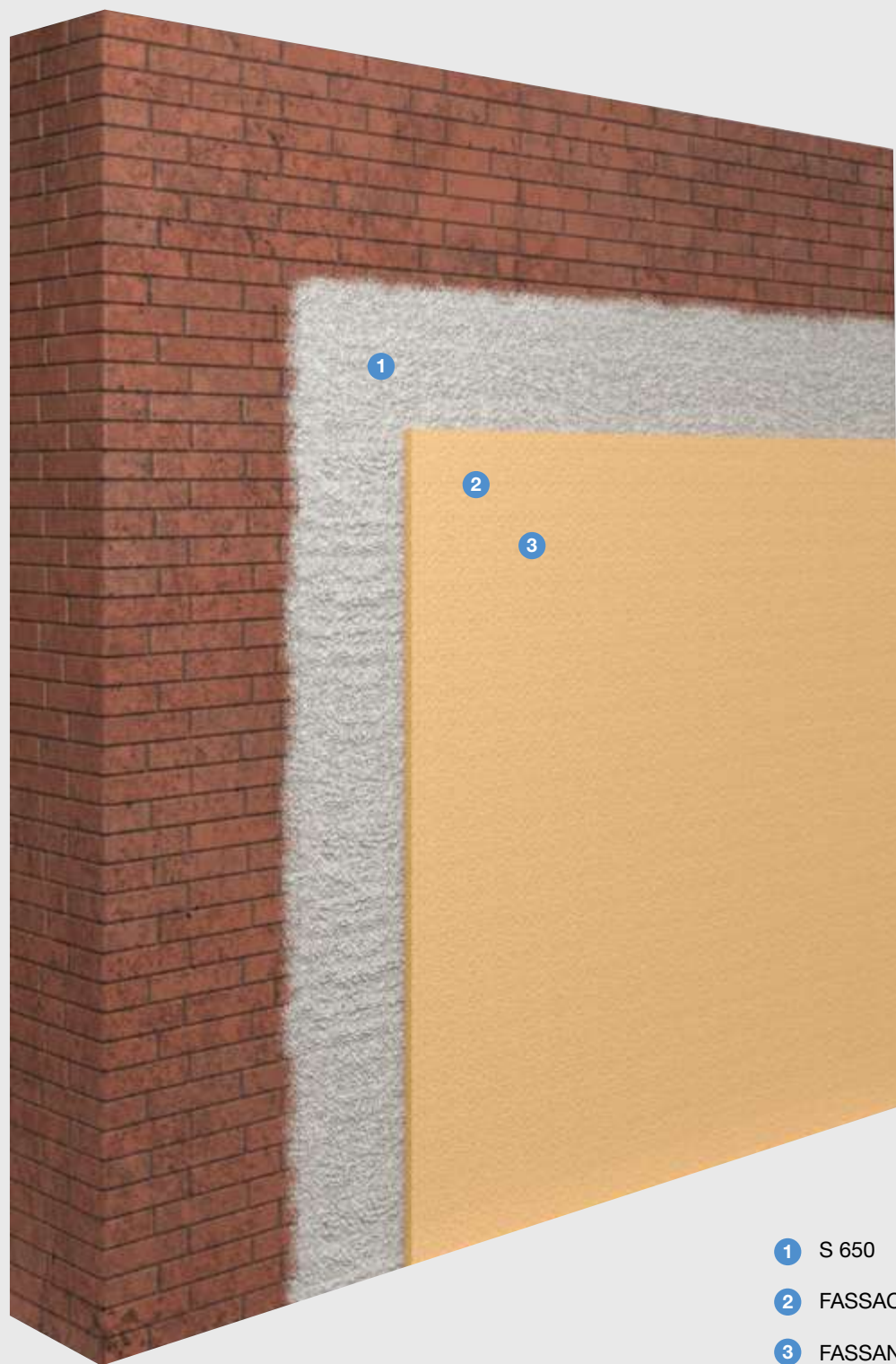

- 1 S 650
- 2 FASSACOUCHE
- 3 FASSANET 160

Rendering cycle using semi-lightweight through-coloured render made from hydrated lime and white hydraulic binder; the product combines high water repellency and excellent breathability, and allows four different finishes: smooth, scratched, sponged, sponge-floated. On non-absorbent substrates or substrates made from different materials, an undercoat is recommended for improved and more uniform adhesion of FASSACOUCHE to the substrate.

- Through-coloured render
- Excellent breathability
- High aesthetic value
- Excellent workability
- Good water repellency

UNDERCOAT



S 650

Bio white undercoat for the restoration of damp masonry, for interiors and exteriors.

BASE COAT



FASSACOUCHE

Semi-lightweight through-coloured render for protecting and decorating facades.



FASSANET 160

Alkali-resistant fibreglass reinforcing mesh, 160 g/m².

EXTRA TOP COAT



IS 510

Siloxane water-repellent.

OR



PX 505

Acrylic-siloxane filling finish for exteriors.

RENDERING ON CONCRETE

Complete cycle with render + finish with mesh + paint



1 SP 22

2 KI 7/ KC 1

3 KZ 35

4 S 605

5 FASSANET 160

6 MIKROS 001/FX 526

7 SKIN 432

Complete application cycle for rendering smooth concrete substrates, after having verified that the surface is clean and free of any traces of grease and/or release oils. The cycle involves application of a cement undercoat to improve adhesion and ensure uniform substrate absorption, followed by lime and cement base coat render. For the base area, it is recommended to apply a specific render with low water absorption. Application of a reinforced base coat using FASSANET 160 fibreglass mesh minimises the risk of hairline cracks forming. The protective siloxane finish gives the substrate good water repellency.

- Minimises the risk of hairline cracks
- Helps minimise any stress in the substrate
- Optimum water repellency
- Complete cycle

UNDERCOAT



SP 22
High performance cement undercoat for concrete substrates for exteriors and interiors.

BASE COAT



KC 1
Lime and cement base coat plaster/render.

OR



KI 7
Fibre reinforced lime/cement base coat plaster and render with water-repellent properties.



KZ 35 (base area)
Lime/cement base coat plaster/render with water-repellent properties for base areas.

FINISH COAT



S 605
Bio white finish coat plaster and render for the restoration of damp masonry, with marmorino effect.



FASSANET 160
Alkali-resistant fibreglass reinforcing mesh, 160 g/m².

PRIMER AND DECORATIVE COAT



FX 526
Universal pigmented primer undercoat for interiors and exteriors.

OR



MIKROS 001
Wall primer in water microemulsion.



SKIN 432
Protective siloxane finish for exteriors.

RENDERING ON CONCRETE

Cycle with render + mineral finish + paint



1 SP 22

2 KI 7/ KC 1

3 KZ 35

4 FASSANET MAXI

5 RM 200

6 MIKROS 001/ FX 526

7 SKIN 432

Application cycle for rendering smooth concrete substrates, after having verified that the surface is clean and free of any traces of grease and/or release oils. The cycle involves application of a cement undercoat to improve adhesion and ensure uniform substrate absorption, followed by lime and cement base coat render with FASSANET MAXI alkali-resistant fibreglass mesh embedded in the surface layer (1/3 from the outer surface).

For the base area, it is recommended to apply a specific render with low water absorption.

Choosing a hydrated lime mineral finish gives the surfaces high aesthetic value and good breathability.

The use of a protective siloxane paint provides greater resistance to the weather.

■ Greater weather resistance

■ Optimum water repellency

■ High aesthetic value

■ Good breathability

UNDERCOAT



SP 22

High performance cement undercoat for concrete substrates for exteriors and interiors.

BASE COAT



KC 1

Lime and cement base coat plaster/render.

OR



KI 7

Fibre reinforced lime/cement base coat plaster and render with water-repellent properties.



KZ 35 (base area)

Lime/cement base coat plaster/render with water-repellent properties for base areas.



FASSANET MAXI

Alkali-resistant fibreglass reinforcing mesh, 160 g/m².

FINISH COAT



RM 200

Bio white mineral-based wall coating for exteriors and interiors.

PRIMER AND DECORATIVE COAT



FX 526

Universal pigmented primer undercoat for interiors and exteriors.

OR



MIKROS 001

Wall primer in water microemulsion.



SKIN 432

Protective siloxane finish for exteriors.

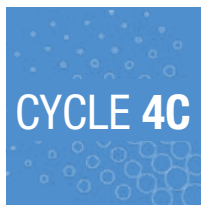

RENDERING ON CONCRETE

Complete cycle with render + mesh + ready-to-use topcoat



1 SP 22

2 KI 7/ KC 1

3 KZ 35

4 FASSANET MAXI

5 FX 526

6 RX 561

Application cycle for rendering smooth concrete substrates, after having verified that the surface is clean and free of any traces of grease and/or release oils. The cycle involves application of a cement undercoat to improve adhesion and ensure uniform substrate absorption, followed by lime and cement base coat render with FASSANET MAXI alkali-resistant fibreglass mesh embedded in the surface layer (1/3 from the outer surface).

For the base area, it is recommended to apply a specific render with low water absorption.

Choosing a ready-to-use acrylic-siloxane finish coat render, available in different gradings and colours, combines excellent water repellency with good breathability.

■ Ready-to-use decorative render
with rustic texture

■ Optimum water repellency
■ Good breathability

UNDERCOAT



SP 22

High performance cement undercoat for concrete substrates for exteriors and interiors.

BASE COAT



KC 1

Lime and cement base coat plaster/render.

OR



KI 7

Fibre reinforced lime/cement base coat plaster and render with water-repellent properties.



KZ 35 (base area)

Lime/cement base coat plaster/render with water-repellent properties for base areas.



FASSANET MAXI

Alkali-resistant fibreglass reinforcing mesh, 160 g/m².

PRIMER AND DECORATIVE COAT



FX 526

Universal pigmented primer undercoat for interiors and exteriors.



RX 561

Rustic acrylic siloxane top coat for exteriors.

RENDERING ON CONCRETE

Cycle with one-coat render



- 1 S 650
- 2 FASSACOUCHE
- 3 FASSANET 160

Rendering cycle using semi-lightweight through-coloured render made from hydrated lime and white hydraulic binder; the product combines high water repellency and excellent breathability, and allows four different finishes: smooth, scratched, sponged, sponge-floated. On smooth substrates such as concrete, an undercoat is recommended to improve adhesion of FASSACOUCHE to the substrate.

- Through-coloured render
- High aesthetic value
- Good water repellency
- Excellent breathability
- Excellent workability

UNDERCOAT



S 650

Bio white undercoat for the restoration of damp masonry, for interiors and exteriors.

BASE COAT



FASSACOUCHE

Semi-lightweight through-coloured render for protecting and decorating facades.



FASSANET 160

Alkali-resistant fibreglass reinforcing mesh, 160 g/m².

EXTRA TOP COAT



IS 510

Siloxane water-repellent.

OR



PX 505

Acrylic-siloxane filling finish for exteriors.

RENDER CARRIER BOARD

Cycle with skim coat + mesh + ready-to-use topcoat



- | | |
|-------------------|----------|
| 1 A 96+ MESH TAPE | 4 FX 526 |
| 2 A 96 | 5 RX 561 |
| 3 FASSANET 160 | |

The application cycle with fibre-reinforced cement base coat is suitable for finishing joints and reinforced levelling of ordinary cement boards, such as Fassa GypsoTech® Externa Light.

Choosing a ready-to-use acrylic-siloxane finish coat render, available in different gradings and colours, combines excellent water repellency with good breathability.

- Good breathability
- Optimum water repellency

- Ready-to-use decorative render with rustic texture in different colours

SUBSTRATE

GYPSOTECH® EXTERNA LIGHT

Lightweight fibreglass-reinforced cement board with polystyrene.



BASE COAT AND JOINT TREATMENT



A 96

Grey and white cement-based adhesive.



MESH TAPE

Self-adhesive glass fibre mesh tape.



FASSANET 160

Alkali-resistant fibreglass reinforcing mesh, 160 g/m².

PRIMER AND DECORATIVE COAT



FX 526

Universal pigmented primer undercoat for interiors and exteriors.



RX 561

Rustic acrylic siloxane top coat for exteriors.

CYCLE 6A

RENDERING ON PAINTED SURFACE (NON-ABSORBENT PAINT)

Cycle with skim coat + mesh + ready-to-use topcoat



1 MIKROS 001*

2 A 96

3 FASSANET 160

4 FX 526

5 RX 561

*for dusting surfaces only

Before applying a base coat on existing paint, the evaluation of the adhesion of the paint to the substrate has to be carried out by the applicator, using a pull-off test where necessary. For dusting surfaces, it is recommended to apply a primer and then smooth off the surface using a fibre-reinforced cement base coat and FASSANET 160 fibreglass mesh.

Choosing a ready-to-use acrylic-siloxane finish coat render, available in different gradings and colours, combines excellent water repellency with good breathability.

- Fibre-reinforced product
- Minimises the risk of hairline cracks
- Optimum water repellency
- Good breathability

PRIMER



MIKROS 001*
Wall primer in water microemulsion.

**for dusting surfaces only*

BASE COAT



A 96
Grey and white cement-based adhesive.



FASSANET 160
Alkali-resistant fibreglass reinforcing mesh, 160 g/m².

PRIMER AND DECORATIVE COAT



FX 526
Universal pigmented primer undercoat for interiors and exteriors.



RX 561
Rustic acrylic siloxane top coat for exteriors.

CYCLE 6B

RENDERING ON PAINTED SURFACE (NON-ABSORBENT PAINT)

Cycle with skim coat + mesh + mineral finish + paint



1 MIKROS 001*

2 A 96

3 FASSANET 160

4 RM 200

5 MIKROS 001

6 SKIN 432

*for dusting surfaces only

Before applying a base coat on existing paint, the evaluation of the adhesion of the paint to the substrate has to be carried out by the applicator, using a pull-off test where necessary. For dusting surfaces, it is recommended to apply a primer and then smooth off the surface using a fibre-reinforced cement base coat and FASSANET 160 fibreglass mesh. Choosing a hydrated lime mineral finish gives the surfaces high aesthetic value and good breathability. The use of a protective siloxane paint provides greater resistance to the weather.

- Greater weather resistance
- High aesthetic value

- Optimum water repellency
- Good breathability

PRIMER



MIKROS 001*
Wall primer in water microemulsion.

**for dusting surfaces only*

BASE COAT



A 96
Grey and white cement-based adhesive.



FASSANET 160
Alkali-resistant fibreglass reinforcing mesh, 160 g/m².

FINISH COAT



RM 200
Bio white mineral-based wall coating for exteriors and interiors.

PRIMER AND DECORATIVE COAT



MIKROS 001
Wall primer in water microemulsion.



SKIN 432
Protective siloxane finish for exteriors.

CYCLE 7A

RENDERING ON PAINTED SURFACE (MINERAL PAINT, ABSORBENT)

Cycle with skim coat + mesh + ready-to-use topcoat



Before applying a base coat on existing paint, the evaluation of the adhesion of the paint to the substrate has to be carried out by the applicator, using a pull-off test where necessary. For absorbent paints (such as lime or mineral paints), it is recommended to apply a fibre-reinforced cement base coat, and FASSANET 160 fibreglass mesh. This product also helps compensate for any unevenness.

Choosing a hydrated lime mineral finish gives the surfaces high aesthetic value and good breathability.

The use of a protective siloxane paint provides greater resistance to the weather.

- Fibre-reinforced product
- Optimum water repellency
- Base coat and smoothing render
- Good breathability

BASE COAT



FASSA K-OVER PLUS 3.30

White fibre-reinforced skim coat and smoothing plaster/render for levelling and restoring interior and exterior surfaces.



FASSANET 160

Alkali-resistant fibreglass reinforcing mesh, 160 g/m².

PRIMER AND DECORATIVE COAT



FX 526

Universal pigmented primer undercoat for interiors and exteriors.



RX 561

Rustic acrylic siloxane top coat for exteriors.

CYCLE 7B

RENDERING ON PAINTED SURFACE (MINERAL PAINT, ABSORBENT)

Cycle with skim coat + mesh + mineral finish + paint



1 FASSA K-OVER
PLUS 3.30

2 FASSANET 160

3 RM 200

4 MIKROS 001/ FX 526

5 SKIN 432

Before applying a base coat on existing paint, the evaluation of the adhesion of the paint to the substrate has to be carried out by the applicator, using a pull-off test where necessary. For absorbent paints (such as lime or mineral paints), it is recommended to apply a fibre-reinforced cement base coat, and FASSANET 160 fibreglass mesh. This product also helps compensate for any unevenness.

Choosing a hydrated lime mineral finish gives the surfaces high aesthetic value and good breathability.

The use of a protective siloxane paint provides greater resistance to the weather.

- Fibre-reinforced product
- Optimum water repellency
- Base coat and smoothing render
- Good breathability

BASE COAT



FASSA K-OVER PLUS 3.30

White fibre-reinforced skim coat and smoothing plaster/render for levelling and restoring interior and exterior surfaces.



FASSANET 160

Alkali-resistant fibreglass reinforcing mesh, 160 g/m².

FINISH COAT



RM 200

Bio white mineral-based wall coating for exteriors and interiors.

PRIMER AND DECORATIVE COAT



FX 526

Universal pigmented primer undercoat for interiors and exteriors.

OR



MIKROS 001

Wall primer in water microemulsion.



SKIN 432

Protective siloxane finish for exteriors.

**FASSAREPAIR
CYCLES**



FASSAREPAIR CYCLES

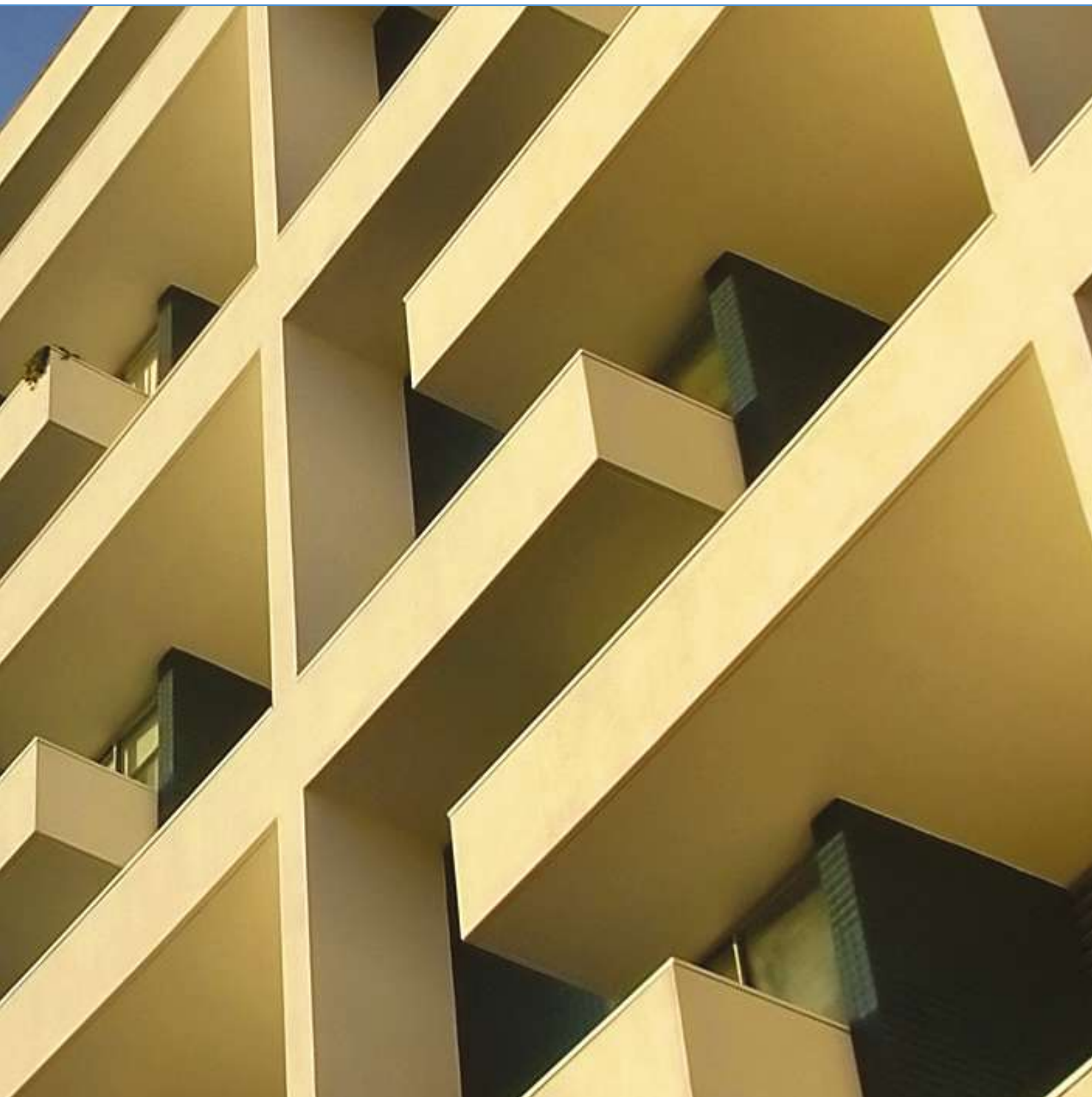

CYCLE 8A

BASE COAT AND CORRECTION OF UNEVENNESS ON CONCRETE (UP TO 10 MM)

Cycle with skim coat + mesh + ready-to-use topcoat



This application cycle is recommended for levelling or correcting any unevenness on smooth concrete surfaces, after first verifying that these are clean and there are no traces of grease or release oils. This cycle should not be applied onto painted surfaces. A specific fibre-reinforced levelling compound for concrete with high mechanical strength can be applied up to 10 mm thick, or used as a levelling compound in combination with FASSANET 160 alkali-resistant fibreglass mesh. Choosing a ready-to-use acrylic-siloxane finish coat render, available in different gradings and colours, combines excellent water repellency with good breathability.

- Fibre-reinforced and water-repellent base coat
- Levels off uneven areas up to 10 mm thick
- Product with high mechanical strength
- Optimum water repellency

BASE COAT



A 64 R-EVOLUTION

Fibre-reinforced, water repellent mineral skim coat made from lime and hydraulic binders, for application on surfaces with high mechanical strength, for interiors and exteriors.



FASSANET 160

Alkali-resistant fibreglass reinforcing mesh, 160 g/m².

PRIMER AND DECORATIVE COAT



FX 526

Universal pigmented primer undercoat for interiors and exteriors.



RX 561

Rustic acrylic siloxane top coat for exteriors.

CYCLE 8B

BASE COAT AND CORRECTION OF UNEVENNESS ON CONCRETE (UP TO 10 MM)

Cycle with skim coat + mesh + elastomer paint



1 A 64
R-EVOLUTION

2 FASSANET 160

3 MIKROS 001

4 C 285 BETON-E

This application cycle is recommended for levelling or correcting any unevenness on smooth concrete surfaces, after verifying that these are clean and there are no traces of grease or check oils. This cycle should not be applied onto painted surfaces. A specific fibre-reinforced levelling compound for concrete with high mechanical strength can be applied up to 10 mm thick, or used as a levelling compound in combination with FASSANET 160 alkali-resistant fibreglass mesh. Application of an elastomer decorative finish specifically tested for concrete surfaces gives the substrate greater resistance to carbonatation and frost.

- Fibre-reinforced and water-repellent base coat
- Levels off uneven areas up to 10 mm thick
- Product with high mechanical strength
- Elastomer finish in compliance with EN 1504-2, specific for concrete
- Protection against carbonatation

BASE COAT



A 64 R-EVOLUTION

Fibre-reinforced, water repellent mineral skim coat made from lime and hydraulic binders, for application on surfaces with high mechanical strength, for interiors and exteriors.



FASSANET 160

Alkali-resistant fibreglass reinforcing mesh, 160 g/m².

PRIMER AND DECORATIVE COAT



MIKROS 001

Wall primer in water microemulsion.



C 285 BETON-E

Protective elastomer finish for concrete for exteriors.

STRUCTURAL REPAIR OF CONCRETE

Cycle with repair mortar + skim coat with mesh + ready-to-use topcoat

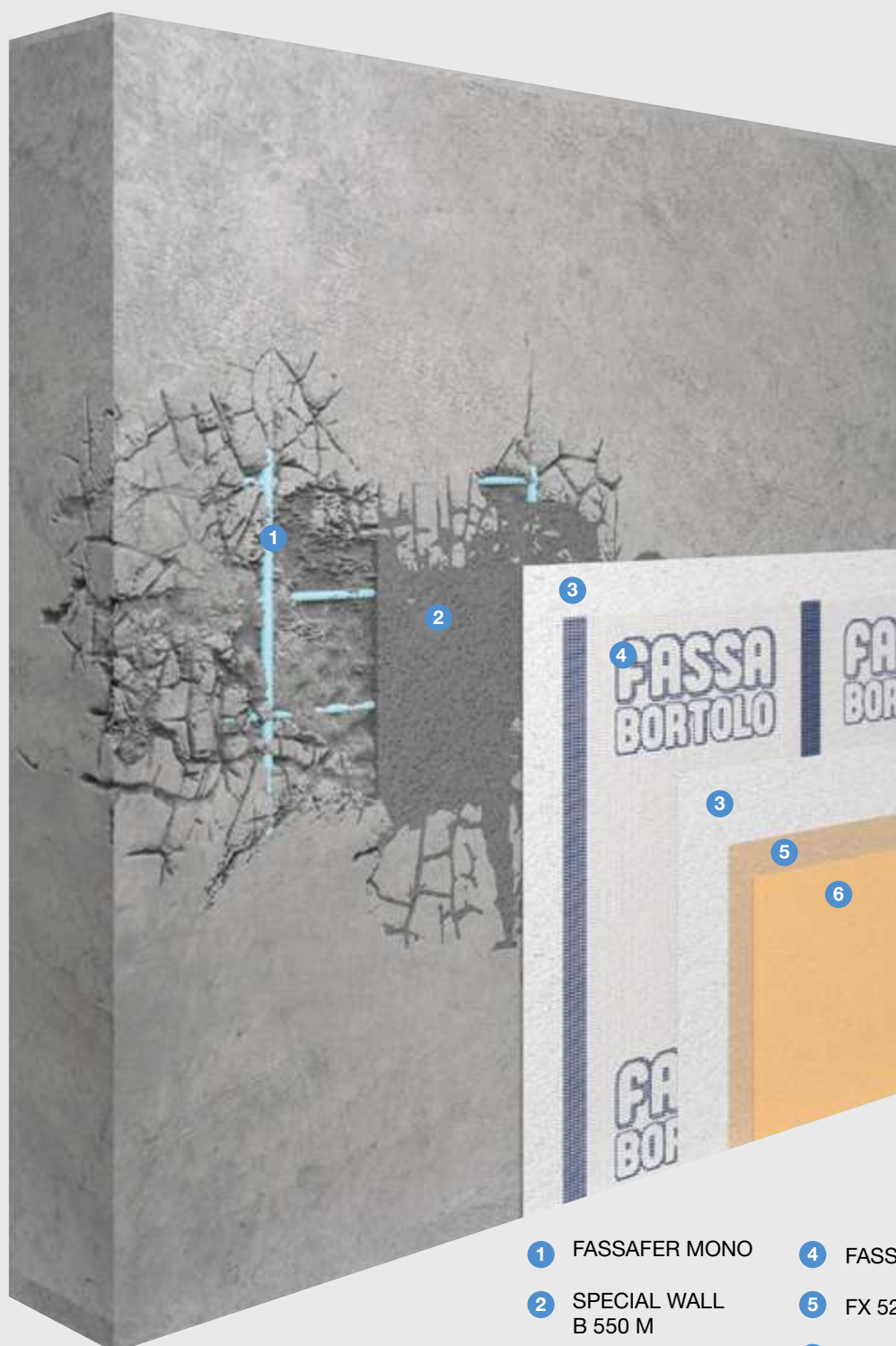

- | | |
|------------------------|----------------|
| 1 FASSAFER MONO | 4 FASSANET 160 |
| 2 SPECIAL WALL B 550 M | 5 FX 526 |
| 3 A 64 R-EVOLUTION | 6 RX 561 |

The concrete repair cycle proposed here is used in situations requiring volumetric and structural repair of highly-degraded concrete elements. The work first requires correct preparation of the substrate, with removal of all sections of deteriorated concrete and brushing of the reinforcing bars, if rusted, until obtaining white metal. A product is then applied for passivation of the reinforcing bars, and subsequently fibre-reinforced and sulphate-resistant mortar for the structural repair of concrete. To complete the cycle, it is recommended to apply reinforced levelling using a fibre-reinforced and water-repellent cement base coat, in combination with FASSANET 160 alkali-resistant fibreglass mesh. Choosing a ready-to-use acrylic-siloxane finish coat render, available in different gradings and colours, combines excellent water repellency with good breathability.

- Passivation and protection of reinforcing bars
- Structural repair of concrete
- Fibre-reinforced, sulphate-resistant mortar with controlled shrinkage
- Fibre-reinforced and water-repellent cement base coat
- Optimum water repellency

IRON BARS



FASSAFER MONO

One-component cementitious treatment for active protection of reinforcing bars.

STRUCTURAL REPAIRING



SPECIAL WALL B 550 M

Fibre-reinforced one-component mortar with controlled shrinkage, sulphate-resistant, for repairing and reinforcing mixed masonry, walls in historic buildings and exterior and interior walls.

BASE COAT



A 64 R-EVOLUTION

Fibre-reinforced, water repellent mineral skim coat made from lime and hydraulic binders, for application on surfaces with high mechanical strength, for interiors and exteriors.



FASSANET 160

Alkali-resistant fibreglass reinforcing mesh, 160 g/m².

PRIMER AND DECORATIVE COAT



FX 526

Universal pigmented primer undercoat for interiors and exteriors.



RX 561

Rustic acrylic siloxane top coat for exteriors.

STRUCTURAL REPAIR OF CONCRETE

Cycle with repair mortar + skim coat with mesh + elastomer paint



- | | | | |
|----------|---------------------------------|----------|----------------------|
| 1 | FASSAFER MONO | 4 | FASSANET 160 |
| 2 | SPECIAL WALL
B 550 M | 5 | MIKROS 001 |
| 3 | A 64 R-EVOLUTION | 6 | C 285 BETON-E |

The concrete repair cycle proposed here is used in situations requiring volumetric and structural repair of highly-degraded concrete elements. The work first requires correct preparation of the substrate, with removal of all sections of deteriorated concrete and brushing of the reinforcing bars, if rusted, until obtaining white metal.

A product is then applied for passivation of the reinforcing bars, and subsequently fibre-reinforced and sulphate-resistant mortar for the structural repair of concrete.

Subsequently, it is recommended to apply reinforced levelling using a fibre-reinforced and water-repellent cement base coat, in combination with FASSANET 160 alkali-resistant fibreglass mesh.

Application of an elastomer decorative finish specifically tested for concrete surfaces gives the substrate greater resistance to carbonatation and frost.

- Passivation and protection of reinforcing bars
- Structural repair of concrete
- Fibre-reinforced, sulphate-resistant mortar with controlled shrinkage
- Fibre-reinforced and water-repellent cement base coat
- Elastomer finish in compliance with EN 1504-2, specific for concrete
- Protection against carbonatation

IRON BAR TREATMENT



FASSAFER MONO

One-component cementitious treatment for active protection of reinforcing bars.

STRUCTURAL REPAIRING



SPECIAL WALL B 550 M

Fibre-reinforced one-component mortar with controlled shrinkage, sulphate-resistant, for repairing and reinforcing mixed masonry, walls in historic buildings and exterior and interior walls.

BASE COAT



A 64 R-EVOLUTION

Fibre-reinforced, water repellent mineral skim coat made from lime and hydraulic binders, for application on surfaces with high mechanical strength, for interiors and exteriors.



FASSANET 160

Alkali-resistant fibreglass reinforcing mesh, 160 g/m².

PRIMER AND DECORATIVE COAT



MIKROS 001

Wall primer in water microemulsion.



C 285 BETON-E

Protective elastomer finish for concrete for exteriors.

PRODUCTS



PRODUCTS

RENDERS

60-67

FASSA MS 20	p.60
SP 22	p.60
KZ 35	p.61
FASSA K-OVER PLUS 3.30	p.61
KD 2	p.62
KC 1	p.62
KI 7	p.63
S 650	p.63
S 605	p.64
RM 200	p.64
FASSAFER MONO	p.65
SPECIAL WALL B 550 M	p.65
A 64 R-EVOLUTION	p.66
FASSACOUCHE	p.66
FASSANET 160	p.67
FASSANET MAXI	p.67
A 96	p.68

PRIMERS AND DECORATIVE COATS

68-72

FX 526	p.68
MIKROS 001	p.69
PX 505	p.69
SKIN 432	p.70
C 285 BETON-E	p.70
RX 561	p.71
RTA 549	p.71
IS 510	p.72

GYPSOTECH PLASTERBOARD SYSTEM

73

EXTERNA LIGHT	p.73
MESH TAPE	p.73

FASSA MS 20

General purpose rendering/plastering mortar.



FASSA MS 20 is a dry premixed mortar composed of hydrated lime, Portland cement, graded sands and specific additives to improve workability and adhesion.

FASSA MS 20 is used as a base coat plaster/render with application by hand or machine on walls made of bricks, concrete blocks, rough concrete, etc.

Grading	< 1.5 mm
Yield	approx. 15 kg/m ² with 10 mm thickness
Minimum thickness	12 mm
Specific weight of the powder	approx. 1,400 kg/m ³
Compressive strength after 28 days (EN 1015-11)	> 2.5 N/mm ²
Water vapour diffusion resistance factor (EN 1015-19)	$\mu < 15$ (measured value)
Supply	Special sacks with protection against moisture, approx. 25 kg



SP 22

High performance cement undercoat for concrete substrates for exteriors and interiors.



SP 22 is a dry mortar made from Portland cement, graded sands and specific additives to improve workability and adhesion.

SP 22 is used as cement-based undercoat on brickwork or concrete substrates on walls and ceilings before applying lime-and-cement-based plasters/renders.

Grading	< 2 mm
Yield	approx. 3-5 kg/m ²
Specific weight of the powder	approx. 1,400 kg/m ³
Compressive strength after 28 days (EN 1015-11)	10 N/mm ² (CSIV: > 6 N/mm ²)
Water vapour diffusion resistance factor (EN 1015-19)	$\mu \leq 32$ (measured value)
Capillary water absorption coefficient (EN 1015-18)	W1 $c \leq 0.40 \text{ kg/m}^2 \cdot \text{min}^{0.5}$
Supply	Special sacks with protection against moisture, approx. 25 kg



KZ 35

Lime/cement base coat plaster/render with water-repellent properties for base areas.



KZ 35 is a dry mortar made from special sulphate-resistant cements, pozzolanic binders, graded sands, water repellent material and specific additives to improve workability and adhesion.

KZ 35 is used as a base coat plaster/render in the base area of walls made of bricks and concrete blocks etc., even if there are traces of sulphates in the wall. KZ 35 is indicated as the ideal external base coat for mineral-based wall coverings.

Grading	< 1.5 mm
Yield	approx. 15 kg/m ² with 10 mm thickness
Minimum thickness	10 mm
Specific weight of the powder	approx. 1,400 kg/m ³
Compressive strength after 28 days	10 N/mm ² (CSIV: > 6 N/mm ²)
Modulus of elasticity after 28 days	9,000 N/mm ²
Water vapour diffusion resistance factor (EN 1015-19)	$\mu \leq 14$ (measured value)
Supply	Special sacks with protection against moisture, approx. 25 kg



FASSA K-OVER PLUS 3.30

White fibre-reinforced skim coat and smoothing plaster/render for levelling and restoring interior and exterior surfaces.



FASSA K-OVER PLUS 3.30 is used as a skim coat and as a smoothing plaster/render for levelling and restoring brick walls, mixed walls with concrete parts and rendered surfaces of existing and new buildings.

FASSA K-OVER PLUS 3.30 can be used as a reinforced skim coat on paints and coatings that are solid, well attached to the substrate and sufficiently absorbent.

Grading	< 1 mm
Yield	approx. 13 kg/m ² with 10 mm thickness
Specific weight of the powder	approx. 1,250 kg/m ³
Compressive strength after 28 days (EN 1015-11)	> 3 N/mm ²
Supply	Special sacks with protection against moisture, approx. 25 kg



KD 2

Lime-and-cement-based fibre-reinforced base coat plaster/render.



KD 2 is a dry mortar made from hydrated lime, Portland cement, graded sands, polymer fibres and specific additives to improve workability and adhesion.

KD 2 is used as a base coat plaster/render on interior and exterior masonry made of bricks, concrete blocks and rough concrete, etc. For special underlays you need to follow the instructions of the supplier.

Grading	< 1.5 mm
Yield	approx. 13.3 kg/m ² with 10 mm thickness
Minimum thickness	10 mm
Compressive strength after 28 days	approx. 1.5 N/mm ²
Modulus of elasticity after 28 days	approx. 2,500 N/mm ²
Water vapour diffusion resistance factor (EN 1015-19)	μ < 12 (measured value)
Supply	Special sacks with protection against moisture, approx. 25 kg



KC 1

Lime and cement base coat plaster/render.



KC 1 is a dry mortar made from hydrated lime, Portland cement, graded sands and specific additives to improve workability and adhesion.

KC 1 is used as a base coat plaster/render on walls made of bricks, concrete blocks, rough concrete etc. For special underlays you need to follow the instructions of the supplier.

Grading	< 1.5 mm
Yield	approx. 13.3 kg/m ² with 10 mm thickness
Minimum thickness	10 mm
Specific weight of the powder	approx. 1,400 kg/m ³
Compressive strength after 28 days (EN 1015-11)	approx. 2.5 N/mm ²
Modulus of elasticity after 28 days	approx. 3,000 N/mm ²
Water vapour diffusion resistance factor (EN 1015-19)	μ ≤ 14 (measured value)
Supply	Special sacks with protection against moisture, approx. 25 kg



KI 7

Fibre reinforced lime/cement base coat plaster and render with water-repellent properties.



Fibre-reinforced KI 7 is a dry mortar made from Portland cement, graded sands, water repellent material, polymer fibres and specific additives to improve workability and adhesion. The particular formulation of fibre-reinforced KI 7 makes it particularly suitable for exterior applications in that it has high water-repellent properties yet still maintains its permeability to water vapour. Fibre-reinforced KI 7 is used as a base coat plaster/render on bricks and honeycombed bricks, concrete blocks, rough concrete, expanded clay etc.

Grading	< 1.5 mm
Yield	approx. 12.8 kg/m ² with 10 mm thickness
Minimum thickness	10 mm
Specific weight of the powder	approx. 1,400 kg/m ³
Compressive strength after 28 days	approx. 2.5 N/mm ²
Modulus of elasticity after 28 days	approx. 3,000 N/mm ²
Water vapour diffusion resistance factor (EN 1015-19)	$\mu \leq 14$ (measured value)
Supply	Special sacks with protection against moisture, approx. 25 kg



S 650

Bio white undercoat for the restoration of damp masonry, for interiors and exteriors



S 650 is a white dry mortar made from natural lime, sulphate-resistant hydraulic binder and graded limestone sands. S 650 is used as a renovation undercoat for damp walls to promote the adhesion of the renovation plaster S 639 to the wall, by enhancing the anti-saline action of the latter.

Grading	< 3 mm
Yield	approx. 3-5 kg/m ²
Thickness	4-5 mm
Compressive strength after 28 days (EN 1015-11)	11 N/mm ² (CSIV: > 6 N/mm ²)
Water vapour diffusion resistance factor (EN 1015-19)	$\mu \leq 15$ (measured value)
Supply	Special sacks with protection against moisture, approx. 25 kg



S 605

Bio white finish coat plaster and render for the restoration of damp masonry, with marmorino effect



S 605 is used as a breathable finish coat plaster/render with marmorino effect. It can be used as a finish coat plaster/render, completing renovation cycles on masonry subject to rising damp.

Grading	< 0.6 mm
Yield	approx. 1.4 kg/m ² per mm in thickness
Specific weight of the powder	approx. 1,300 kg/m ³
Compressive strength after 28 days (EN 1015-11)	approx. 2.5 N/mm ²
Modulus of elasticity after 28 days	approx. 3,500 N/mm ²
Water vapour diffusion resistance factor (EN 1015-19)	$\mu \leq 12$ (measured value)
Supply	Special sacks with protection against moisture, approx. 25 kg



RM 200

Bio white mineral-based wall coating for exteriors and interiors



RM 200 is a special wall coating made from natural lime, hydraulic binder, superior graded sands, water repellent material and special additives to improve workability and adhesion. The nature of the raw materials used makes the masonry wall perfectly breathable.

RM 200 is used as decorative plaster/render for exteriors and interiors.

Grading	≤ 2 mm
Yield	approx. 3.3 kg/m ² per layer
Compressive strength after 28 days (EN 1015-11)	CSII
Water vapour diffusion resistance factor (EN 1015-19)	$\mu \leq 14$ (measured value)
Supply	Special sacks with protection against moisture, approx. 25 kg



FASSAFER MONO

One-component cementitious treatment for active protection of reinforcing bars.



FASSAFER MONO is a product made from special cements, graded sands, resins and specific additives to protect iron reinforcement from corrosion. It is used to protect reinforcement rods against corrosion before the application of mortar for repairing concrete.

Grading	< 0.2 mm
Density of hardened mortar	approx. 1,800 kg/m ³
Consumption	approx. 150 g/m with 10 mm steel bars
Waiting time before application of mortar for repairing concrete	minimum 5 hours
Supply	Small packs of approx. 5 kg in boxes of 5 pcs



SPECIAL WALL B 550 M

Fibre-reinforced one-component mortar with controlled shrinkage, sulphate-resistant, for repairing and reinforcing mixed masonry, walls in historic buildings and exterior and interior walls.



SPECIAL WALL B 550 M is indicated for the consolidation or structural reinforcement with welded metal mesh of masonry and concrete structures. It is also used to repair the edges of beams and pillars, to repair deteriorated cornices and balconies and to reconstruct concrete when medium mechanical strength is required. SPECIAL WALL B 50 M is applied in thicknesses exceeding 10 mm. Do not use on gypsum, painted surfaces, or on mechanically weak and carbonated substrates in general.

Grading	< 3 mm
Yield	approx. 18 kg/m ² with 10 mm thickness
Specific weight of the powder	approx. 1,500 kg/m ³
Workability time (at 20°C and 65% RH)	approx. 30 minutes
Supply	Special sacks with protection against moisture, approx. 25 kg



A 64 R-EVOLUTION

Fibre-reinforced, water repellent mineral skim coat made from lime and hydraulic binders, for application on surfaces with high mechanical strength, for interiors and exteriors.



UK
CA



A 64 R-EVOLUTION is a mineral-based skim coat for interiors and exteriors featuring high dimensional stability and excellent mechanical characteristics. The product is used for smoothing off particularly solid irregular surfaces, both absorbent and non-absorbent (such as concrete, very hard plasters, strongly bonded plastic coatings, etc.).

Grading	< 0.6 mm
Yield	for smoothing: approx. 1.5 kg/m ² per mm in thickness
Thickness	2-10 mm
Specific weight of the powder	approx. 1,300 kg/m ³
Compressive strength after 28 days (EN 12190)	> 15 N/mm ²
Supply	Special sacks with protection against moisture, approx. 25 kg



FASSACOUCHE

Semi-lightweight through-coloured render for protecting and decorating facades.



UK
CA



FASSACOUCHE is a semi-lightweight coating made from natural lime, white cement, graded sand, perlite, mineral pigments and specific additives.

Fassacouche is used as a through-coloured render for exteriors, on both new and existing buildings, over medium density (1,400 to 1,800 kg/m³) concrete blockwork compliant with BS 771-3 : 2011, with a compressive strength of 7.3 N/mm².

FASSACOUCHE is not recommended for use on gypsum coatings.

Grading	< 1.6 mm
Minimum thickness	12 mm
Density of powder	1,250 ± 50 kg/m ³
Consumption (*)	approx. 13 kg/m ² when applied to a thickness of 10 mm
Supply	Special sacks with protection against moisture, 25 kg Available in 25 colours

(*) consumption of material varies depending on the type of finishing



FASSANET 160

Alkali-resistant fibreglass reinforcing mesh,
160 g/m²



FASSANET 160 is a product made from the weaving of high quality fibreglass yarns, which then undergoes special treatment with impregnation to make the mesh alkali-resistant.

FASSANET 160 must be used to reinforce base-coats applied on renders or on thermal insulation panels before applying the finishing coat.

Mesh size	4.15x3.8 mm approx.
Fibreglass	approx 80%
Mass per unit area (alkali-resistant mesh)	157 g/m ² ± 5%
Supply	50 m rolls, 1 m wide

FASSANET MAXI

Alkali-resistant fibreglass reinforcing mesh,
160 g/m²



FASSANET MAXI is a product made from the weaving of high quality fibreglass yarns, which then undergoes special treatment with impregnation to make the mesh alkali-resistant. Its technical characteristics and the type of treatment applied ensure the system can withstand impact, as well as respond to the stress deriving from sudden changes in temperature and shrinkage, minimizing the formation of cracks or fissures. Its features make it ideal for use on lightweight skim coats applied in thick layers.

The size of the mesh means it is especially suitable for use with medium-coarse gradings.

Mesh size	7.1x7.7 mm approx.
Fibreglass	approx. 79%
Mass per unit area (alkali-resistant mesh)	155 g/m ² ± 5%
Supply	50 m rolls, 1 m wide

A 96

Grey and white cement-based adhesive.



A 96 is a premixed adhesive made from Portland cement, synthetic fibres, selected limestone sands and specific additives to improve workability and adhesion.

A 96 is used to bond and skim-coat polystyrene panels, Styrodur and Styrofoam, and mineral-wool panels in the external thermal insulation composite systems. It is also used to embed reinforcing meshes and to skim-coat concrete surfaces and pre-fabricated units.

Grading	< 1.4 mm
Specific weight of the powder	approx. 1,350 kg/m ³
Compressive strength after 28 days (EN 1015-11)	≥ 7 N/mm ²
Water vapour diffusion resistance factor (EN 1015-19)	μ = 25 (measured value)
Supply	Special sacks with protection against moisture, approx. 25 kg



FX 526

Universal pigmented primer undercoat for interiors and exteriors



FX 526 is a pigmented undercoat made from special copolymers in aqueous emulsion, graded aggregate, titanium dioxide, pigments and specific additives to improve adhesion and application.

FX 526 is used in interiors and exteriors as a filling primer-undercoat that, thanks to its hiding power and levelling properties, creates a coloured, uniform surface. It is used on lime and lime-cement finish coat and skim coat plasters and renders before applying water-based coatings, such as RTA 549, RSR 421, RX 561, and water-based paints. The fine aggregate used improves anchoring of the finish both on external thermal insulation composite systems and on already painted masonry substrates.

Grading	approx. 0.2 mm
Dilution	(with water) approx. 5%
Specific weight	approx. 1.61 kg/l
Consumption (**)	from 200 to 250 g/m ² (from 0.12-0.16 l/m ²) per layer
Yield (**)	6-8 m ² /l per layer
Supply	Buckets of approx. 5 and 14 l Tints: a selection from our 365 A YEAR OF COLORS swatchbook

(**) The consumption and yield values refer to the white product applied on smooth substrates of average absorbance; these should be verified by preliminary tests on the specific substrate, in relation to the chosen colour.



MIKROS 001

Wall primer in water microemulsion.



MIKROS 001 is a transparent and odourless water-dilutable primer with extremely low VOC emissions, made from special acrylic copolymers in water microemulsion. The specific formulation does not include organic solvents or plasticisers. MIKROS 001 is used as a primer for interior and exterior walls, before applying finish coat products from the GREEN VOCATION, SFIDE D'ARTE, ACRYLIC, ACRYLIC-SILOXANE and DECORCALCE lines. The ultra-fine polymeric particles ensure excellent penetration and impregnation of the substrate.

Yield (**)	8-14 m ² /l depending on the substrate absorption
Consumption (**)	0.07-0.125 l/m ² depending on the substrate absorption
Specific weight of powder (EN ISO 2811-1)	approx. 1.00 kg/l
Supply	Buckets of approx. 12 l and 4 l

(**) this should be verified by preliminary tests on the specific substrate.



PX 505

Acrylic-siloxane filling finish for exteriors.



PX 505 is used as a decorative and protective paint for exteriors, white or coloured, on both new and existing floatfinished lime-cement finish coat renders, concrete, etc. It can also be applied on existing painted surfaces and coatings, as long as these are well attached, sound and not crumbling.

Yield (**)	4-5 m ² /l for finished work (2 layers)
Consumption (**)	150-200 g/m ² (0.10-0.13 l/m ²) per layer
Specific weight (EN ISO 2811-1)	approx. 1.47-1.57 kg/l (depending on the base colour)
Supply	Containers of 5 and 14 l Tints: a selection from our 365 A YEAR OF COLORS swatchbook

(**) The consumption and yield values refer to the product applied on smooth substrates of average absorbance; these should be verified by preliminary tests on the specific substrate, in relation to the chosen colour.



SKIN 432

Protective siloxane finish for exteriors



SKIN 432 is a water-based paint made from the latest generation organic copolymers and enriched with special siloxane resins in aqueous emulsion, graded aggregates, titanium dioxide, pigments and specific additives to improve application and give the product higher broad-spectrum protection against the growth of algae and mould species.

SKIN 432 is used as a high-performance protective and decorative paint for exteriors, white or coloured, on both new and existing lime, lime-cement finish coat renders, concrete, etc.

Yield (**)	4-5 m ² /l for finished work (2 layers)
Consumption (**)	150-200 g/m ² (0.10-0.13 l/m ²) per layer
Specific weight (EN ISO 2811-1)	approx. 1.52-1.56 kg/l (depending on the base colour)
Supply	Containers of approx. 14 l Tints: a selection from our 365 A YEAR OF COLORS swatchbook

(**) The values refer to white product applied on smooth substrates of average absorbance; these should be verified by preliminary tests on the specific substrate, in relation to the chosen colour.



C 285 BETON-E

Protective elastomer finish for concrete for exteriors.



UK
CA



C 285 BETON-E is a paint made from special acrylic copolymers in aqueous emulsion, graded inert fillers, titanium dioxide, pigments and specific additives to improve application. Moreover, special molecules provide the product additional broad-spectrum protection against the growth of algae and mould species. C 285 BETON-E is a one-component water-based paint that creates a film on the surface through exposure to natural light; it is used as a protective and decorative finish on concrete structures, protecting them against carbonatation, or as a finish on lime-cement plasters and renders with microcracks (maximum width 0.3 mm). C 285 BETON-E, after drying, features excellent resistance to ageing, frost and de-icing salts.

Recommended yield (**)	1.7-3.6 m ² /l for finished work (2 layers)
Recommended consumption (**)	200-400 g/m ² (0.14-0.29 l/m ²) per layer
Specific weight (EN ISO 2811-1)	approx. 1.40 kg/l
Can be painted over (20°C and 65% R.H.)	approx. 24 hours
Supply	Containers of approx. 14 l
Tints	selection of greys from the 365 A YEAR OF COLORS swatchbook

(**) The values refer to white product applied on smooth substrates of average absorbance; these should be verified by preliminary tests on the specific substrate, in relation to the chosen colour.



RX 561

Rustic acrylic siloxane top coat for exteriors.



RX 561 is used as a top coat for decorating and protecting exterior façades. The nature of the raw materials used in the formulation gives the surface a rustic appearance. RX 561 is used on lime-cement base coat render, on base coats reinforced with alkali-resistant fibreglass mesh and on the FASSATHERM external wall insulation system.

Grading	0.6 - 1 - 1.5 - 2 - 3 mm
Dilution	add up to 2% water if necessary
Specific weight	1.70-1.90 kg/l
Supply	Containers of approx. 25 kg - Tints: a selection from our 365 A YEAR OF COLORS swatchbook

* ETA and BBA certificates available for the gradings 1-1.5-2 and 3 mm only.



RTA 549

Acrylic coating for thermal insulated walls for exteriors.



RTA 549 is a paste top coat made from special acrylic copolymers in aqueous emulsion, graded limestone aggregate, microfibres, pigments and specific additives to improve workability and adhesion.

RTA 549 is mainly used as a special protective and decorative coating for exteriors on walls insulated with the external thermal insulation composite system.

Specific weight	1.70-1.90 kg/l
Gradings	1 - 1.5 - 2
Supply	Containers of approx. 25 kg - Tints: a selection from our 365 A YEAR OF COLORS swatchbook



IS 510

Siloxane water-repellent.



UK
CA



IS 510 is a transparent and colourless water repellent coating made from special solvent-modified siloxane resins.

IS 510 is used to provide greater water repellency when treating substrates such as facing brick, small concrete structures and stone in general.

Specific weight (EN ISO 2811-1)	approx. 0.8 kg/l
Consumption (**)	approx. 0.1-1.0 l/m ² depending on absorption of the substrate being treated
Supply	Approx. 5 l and 20 l

(**) this should be verified by preliminary tests on the specific substrate.



EXTERNA LIGHT

Cement board



Lightweight fibreglass-reinforced cement board, designed to be applied both on the inside and outside of the building.

Regulations	ETA 19-0145
Thickness (mm)	12,5
Width (mm)	1.200
Length (mm)	2.000
Weight (kg/m²)	12

MESH FOR CARRIER BOARD JOINTS

Mesh tape



Reinforcing mesh for joints
150 mm x 50 m

Roll length m	50 m
Grammage	160 g/m ²
MOQ	1 box
Rolls per box	6

FASSA GROUP

Headquarters

FASSA S.r.l.

Via Lazzaris, 3 - 31027 Spresiano (Treviso), Italy
tel. +39 0422 7222 - fax +39 0422 887509
www.fassabortolo.com - fassa@fassabortolo.it

PRODUCTION FACILITIES

Italy

FASSA S.r.l.

Spresiano (Treviso) - tel. +39 0422 521945 - fax +39 0422 725478
Artena (Rome) - tel. +39 06 951912145 - fax +39 06 9516627
Bagnasco (Cuneo) - tel. +39 0174 716618 - fax +39 0422 723041
Bitonto (Bari) - tel. +39 080 5853345 - fax +39 0422 723031
Calliano (Asti) - tel. +39 0141 915145 - fax +39 0422 723055
Mazzano (Brescia) - tel. +39 030 2629361 - fax +39 0422 723065
Molazzana (Lucca) - tel. +39 0583 641687 - fax +39 0422 723045
Moncalvo (Asti) - tel. +39 0141 911434 - fax +39 0422 723050
Montichiari (Brescia) - tel. +39 030 9961953 - fax +39 0422 723061
Popoli (Pescara) - tel. +39 085 9875027 - fax +39 0422 723014
Ravenna - tel. +39 0544 688445 - fax +39 0422 723020
Sala al Barro (Lecco) - tel. +39 0341 242245 - fax +39 0422 723070
Ceraio di Dolcè (Verona) - tel. +39 045 4950289 - fax +39 045 5112472
Villaga (Vicenza) - tel. +39 0444 886711 - fax +39 0444 886651

IMPA S.p.A. Unipersonale

San Pietro di Feletto (Treviso) - tel. +39 0438 4548 - fax +39 0438 454915

CALCE BARATTONI S.p.A.

Schio (Vicenza) - tel. + 39 0445 575130 - fax +39 0445 575287

Spain

YEDESA S.A.

Antas (Almeria) - tel. 950 61 90 04

Portugal

FASSALUSA Lda

São Mamede (Batalha) - tel. +351 244 709 200 - fax +351 244 704 020

Brazil

FASSA DO BRASIL INDÚSTRIA E COMÉRCIO LTDA

MATOZINHOS (Minas Gerais) - tel. (31) 3010400

Central de atendimento - 0800 800 2024

COMMERCIAL BRANCHES

Italy

FASSA S.r.l.

Altopascio (Lucca) - tel. +39 0583 216669 - fax +39 0422 723048
Bolzano - tel. +39 0471 203360 - fax +39 0422 723008
Sassuolo (Modena) - tel. +39 0536 810961 - fax +39 0422 723022

Switzerland

FASSA SA

Mezzovico (Lugano) - tel. +41 (0) 91 9359070 - fax +41 (0) 91 9359079
Aclens - tel. +41 (0) 21 6363670 - fax +41 (0) 21 6363672
Dietikon (Zurigo) - tel. + 41 (0) 43 3178588 - fax +41 (0) 43 3211712

France

FASSA FRANCE Sarl

Lyon - tel. 0800 300338 - fax 0800 300390

Spain

FASSA HISPANIA SL

Madrid - tel. +34 900 973 510



DEP349UKA_ 06/2023

FASSA UK Ltd

Fassa House
Ashchurch Business Centre
Alexandra Way
Ashchurch
Tewkesbury GL20 8TD
www.fassabortolo.com

ORDERS

orders.uk@fassabortolo.com
Tel. +44 (0)1684 212272

SALES ENQUIRIES

info.fassauk@fassabortolo.com
Tel. +44 (0)1684 218305

